



GPL series

GPL 12880 12V 94AH



Valve Regulated Lead Acid Battery

Maintenance-Free Sealed Lead Acid Battery.
Absorbent Glass Mat (AGM) technology for efficient gas recombination of up to 99%.

Design for Standby Power Applications

| | |
|---|---|
| <p>【Design Life】 Up to 10 Years in Standby Service at 25°C Eurobat (20°C) : 10-12 years, Long Life</p> <p>【Operating Temperature Range】 Nominal Operating Temperature : 25°C (77°F) Discharge : -15°C ~ 50°C (5°F~122°F) Charge: -15°C ~ 40°C (5°F~104°F) Storage: -15°C ~ 40°C (5°F~104°F)</p> | <p>【Float Charging Voltage】 13.5 ~ 13.8 VDC/Unit at 25°C (77°F)</p> <p>【Equalization Charging Voltage】 14.4 ~ 15.0 VDC/Unit at 25°C (77°F)</p> <p>【Self Discharge】 Less than 10% after 90 days, can be stored up to 6 months at 25°C (77°F); Fully recharging is required before usage, and charged sooner if stored at higher temperature than 25°C (77°F).</p> |
|---|---|

| Specification | | Design according with IEC 60896-21/22: 2004 | |
|---------------------------|--|---|-----------------|
| Nominal Voltage | 12V (6 cells per unit) | | |
| Nominal Capacity | 94 Ah @20hr-rate to 1.75V per cell @25°C (77°F) | | |
| Weight | Approx. 29.70 Kg (65.46 lbs) | | |
| Maximum Discharge Current | 800A (5sec) | | |
| Internal Resistance | Approx. 3.6mΩ | | |
| Short Circuit Current | 2098A | | |
| Maximum Charge Current | 26.40A | | |
| Terminal type | I2 thread lead alloy terminal to accept M6 bolt | | |
| Terminal hardware Torque | 138.6 Kgf-cm/ 120.3 lbf-in/ 13.58 N-m | | |
| Container Material | PP (UL 94-HB) & Flame Retardant (94-V0) available upon request | | |
| Dimensions | Length (L) | 308.7±2.5 mm | 12.15±0.10 inch |
| | Width (W) | 169.0±2.0 mm | 6.65±0.08 inch |
| | Container Height (h) | 210.6±2.5 mm | 8.29±0.10 inch |
| | Overall Height (H) | 213.6±2.5 mm | 8.41±0.10 inch |
| | Terminal Height | 25.55 [1.01] | 1.01 [2.41] |

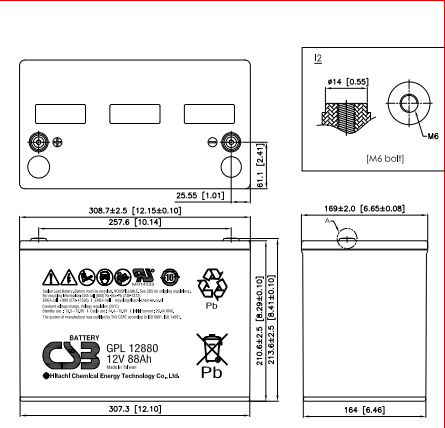

| Constant Current Discharge Characteristics Unit: A (25°C, 77°F) | | | | | | | | | | | | |
|---|------|-------|-------|-------|-------|-------|------|------|------|------|------|------|
| F.V/Time | 5MIN | 10MIN | 15MIN | 30MIN | 60MIN | 90MIN | 2HR | 3HR | 5HR | 8HR | 10HR | 20HR |
| 1.60V | 349 | 232 | 175 | 103 | 62.8 | 45.5 | 36.3 | 25.6 | 17.0 | 11.3 | 9.21 | 4.87 |
| 1.67V | 321 | 225 | 171 | 102 | 62.4 | 45.2 | 36.0 | 25.5 | 16.9 | 11.2 | 9.12 | 4.84 |
| 1.70V | 311 | 219 | 169 | 101 | 61.4 | 44.8 | 35.7 | 25.2 | 16.8 | 11.1 | 9.10 | 4.83 |
| 1.75V | 274 | 199 | 163 | 99 | 60.3 | 43.9 | 35.1 | 25.1 | 16.6 | 11.0 | 8.96 | 4.74 |
| 1.80V | 246 | 186 | 154 | 96.1 | 58.8 | 43.1 | 34.6 | 24.6 | 16.2 | 10.8 | 8.85 | 4.66 |
| 1.85V | 215 | 170 | 138 | 90.3 | 55.8 | 41 | 32.9 | 23.8 | 15.8 | 10.4 | 8.51 | 4.48 |

| Constant Power Discharge Characteristics Unit: W (25°C, 77°F) | | | | | | | | | | | | |
|---|------|-------|-------|-------|-------|-------|-----|-----|-----|-----|------|------|
| F.V/Time | 5MIN | 10MIN | 15MIN | 30MIN | 60MIN | 90MIN | 2HR | 3HR | 5HR | 8HR | 10HR | 20HR |
| 1.60V | 3535 | 2496 | 1941 | 1177 | 720 | 535 | 434 | 306 | 203 | 136 | 110 | 58.3 |
| 1.67V | 3307 | 2417 | 1919 | 1169 | 719 | 531 | 428 | 305 | 202 | 135 | 109 | 57.9 |
| 1.70V | 3202 | 2373 | 1888 | 1166 | 716 | 529 | 426 | 304 | 201 | 134 | 108 | 57.8 |
| 1.75V | 2995 | 2261 | 1828 | 1145 | 707 | 524 | 424 | 301 | 200 | 132 | 107 | 57.5 |
| 1.80V | 2782 | 2129 | 1734 | 1113 | 694 | 516 | 418 | 298 | 198 | 130 | 106 | 57.1 |
| 1.85V | 2434 | 1955 | 1581 | 1061 | 671 | 495 | 400 | 287 | 190 | 125 | 103 | 55.3 |

Please refer to the official site for the latest rating confirmation. URL: www.csb-battery.com Issued: 170201

Sales Offices
日立化成能源科技股份有限公司
 Hitachi Chemical Energy Technology Co., Ltd.

BUSINESS HEADQUARTERS
 Tel: +886-2-2880-5600
 Fax: +866-2-2888-3300

USA OFFICE
 Tel: +1-817-244-7777 / 1-(800)3-CSB-USA (272872)
 Fax: +1-817-244-4445

SHENZHEN OFFICE (CHINA)
 Tel: +86-755-8831-6488, 8831-6775
 Fax: +86-755-8831-6075

EUROPE (EMEA) OFFICE
 Tel: +31(0)180-418-140
 Fax: +31(0)180-418-327

SHANGHAI OFFICE (CHINA)
 Tel: +86-21-5046-1622, 5046-0833
 Fax: +86-21-5046-1046

Recognized under UL 1989,
and certified by ISO 9001, 14001.

TAIPEI OFFICE
 Tel: +886-2-2880-5600
 Fax: +866-2-2888-3300

BEIJING OFFICE (CHINA)
 Tel: +86-10-5820-5336, 5820-5338
 Fax: +86-10-5820-3053