



UPS series

UPS 12460 12V 460W



Valve Regulated Lead Acid Battery

Maintenance-Free Sealed Lead Acid Battery.

Absorbent Glass Mat (AGM) technology for efficient gas recombination of up to 99%.

Design for Standby Power Applications

【Design Life】

Up to 5 Years in Standby Service at 25°C

Eurobat (20°C) : 3-5 years, Standard Commercial

【Operating Temperature Range】

Nominal Operating Temperature : 25°C (77°F)

Discharge : -15°C ~ 50°C (5°F~122°F)

Charge: -15°C ~ 40°C (5°F~104°F)

Storage: -15°C ~ 40°C (5°F~104°F)

【Float Charging Voltage】

13.5 ~ 13.8 VDC/Unit at 25°C (77°F)

【Equalization Charging Voltage】

14.4 ~ 15.0 VDC/Unit at 25°C (77°F)

【Self Discharge】

Less than 10% after 90 days, can be stored up to 6 months at 25°C (77°F);

Fully recharging is required before usage, and charged sooner if stored at higher temperature than 25°C (77°F).

Specification

Design according with IEC 61056-1/2:2012

Nominal Voltage	12V (6 cells per unit)	
Nominal Capacity	460W @5min-rate to 9.60V per PCS @25°C (77°F)	
Weight	Approx. 2.50 Kg (5.51 lbs)	
Maximum Discharge Current	130 A (5sec)	
Internal Resistance	Approx. 16.60 mΩ	
Short Circuit Current	450A	
Maximum Charge Current	3.8 A	
Terminal type	F2 terminal -Faston Tab 250	
Terminal hardware Torque	--	
Container Material	ABS (UL 94-HB) & Flame Retardant (94-V0) available upon request	
Dimensions	Length (L)	150.9±2.0 mm 5.94±0.08 inch
	Width (W)	64.8±1.0 mm 2.55±0.04 inch
	Container Height (h)	94.3±1.0 mm 3.71±0.04 inch
	Overall Height (H)	98.6±1.0 mm 3.88±0.04 inch

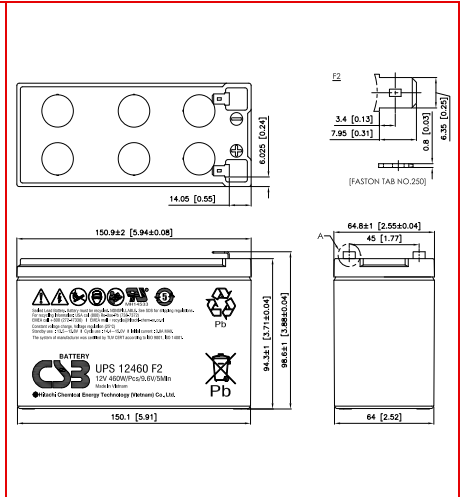

Constant Current Discharge Characteristics Unit: A (25°C, 77°F)

F.V/Time	2MIN	4MIN	5MIN	6MIN	8MIN	10MIN	15MIN	20MIN	30MIN	45MIN	60MIN	90MIN
1.60V	77.2	52.7	44.9	39.7	32.3	27.3	19.9	15.9	11.6	8.37	6.65	4.80
1.67V	69.5	50.0	43.4	38.7	31.7	26.9	19.7	15.7	11.5	8.33	6.63	4.78
1.70V	66.0	48.6	42.4	37.9	31.1	26.5	19.6	15.6	11.4	8.29	6.60	4.75
1.75V	60.5	45.1	39.9	35.6	29.8	25.4	19.0	15.3	11.3	8.19	6.52	4.72
1.80V	53.8	41.1	36.5	33.0	27.8	24.0	18.2	14.7	11.0	7.98	6.38	4.62
1.85V	46.3	36.0	32.1	29.4	24.9	21.8	16.8	13.8	10.4	7.63	6.12	4.43

Constant Power Discharge Characteristics Unit: W (25°C, 77°F)

F.V/Time	2MIN	4MIN	5MIN	6MIN	8MIN	10MIN	15MIN	20MIN	30MIN	45MIN	60MIN	90MIN
1.60V	710	520	460	412	343	296	224	180	133	96.8	77.3	56.4
1.67V	673	500	444	400	338	291	221	178	132	96.3	77.0	56.2
1.70V	650	489	435	394	334	288	220	177	131	96.1	76.7	56.0
1.75V	605	462	414	378	321	280	215	175	130	95.4	76.4	55.7
1.80V	555	429	387	356	303	266	207	168	128	93.6	75.1	54.7
1.85V	486	387	355	324	276	244	189	158	122	89.6	72.2	52.8

Please refer to the official site for the latest rating confirmation. URL: www.csb-battery.com

Issued: 170306

Sales Offices

日立化成能源科技股份有限公司
Hitachi Chemical Energy Technology Co., Ltd.

BUSINESS HEADQUARTERS

Tel: +886-2-2880-5600

Fax: +866-2-2888-3300

USA OFFICE

Tel: +1-817-244-7777 / 1-(800)3-CSB-USA (272872)

Fax: +1-817-244-4445

SHENZHEN OFFICE (CHINA)

Tel: +86-755-8831-6488, 8831-6775

Fax: +86-755-8831-6075

EUROPE (EMEA) OFFICE

Tel: +31(0)180-418-140

Fax: +31(0)180-418-377

SHANGHAI OFFICE (CHINA)

Tel: +86-21-5046-1622, 5046-0833

Fax: +86-21-5046-1046

TAIPEI OFFICE

Tel: +886-2-2880-5600

Fax: +866-2-2888-3300

BEIJING OFFICE (CHINA)

Tel: +86-10-5820-5336, 5820-5338

Fax: +86-10-5820-3053

Recognized under UL 1989,
and certified by ISO 9001, 14001.

